

f **STAYFIX**

ARCHITECTURAL ALUMINIUM SYSTEMS



Climate II PA Door

Door system

Climate II PA Door

Our innovative door system offers all three main criteria's for a door specification. A clean and appealing appearance, weather and security tested, and compliance to the building regulations.

Having gone through various design stages, our door system only comprises with the best elements. Being internally beaded for security, 70mm profile for strength and stability and an inline design, makes this system one of finest door systems in the market.

With the door being the most accessed and used part in any building, therefore we understand how important it is to have a system that can not only withstand normal forces on the door, but also maintain its structure for weather proofing and security. The system has been tested to PAS 23 and 24, as well as BS 6375: Part 1:2009.

While having maximum polyamide thermal break of 28mm and 70mm depth of profile, it is one of the most energy efficient systems in the industry. With the ever demanding government regulations on protecting the environment, we have ensured that the materials used can be recycled with minimal waste in the future.



> Three point locking
Shootbolt locking for double doors

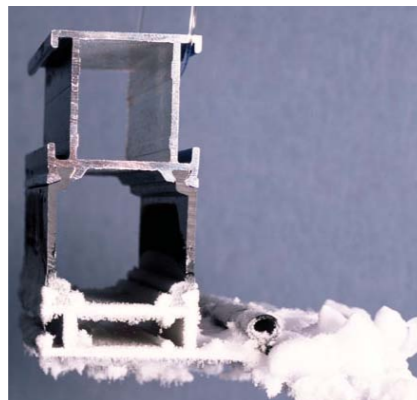

> Demonstration of polyamides
resistance to low temperatures

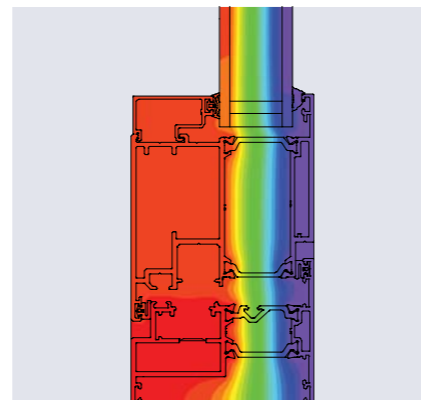

> Thermal conductance through
the system

Technical specification

System casement options

- > Single or double door configuration
- > Low threshold option
- > Internally beaded

Material

- > Extruded from aluminium alloy 6060 T6
- > Polyamide 6.6.25% reinforced with glass fibre

Finishes

- > Polyester powder coated to BSEN 12206
- > Qualicoat and GSB label
- > Mill Finish
- > Silver anodized
- > Dual colour option

System Features

- > Internally beaded for extra security
- > Fully compliance with Part L of the building regulations
- > Three thermal chambers
- > Simple to manufacture and install

Application

- > Residential as well as commercial
- > Exterior or interior

Weather Performance

- > Tested to BS 6375 Part 1:2009 Part 1: Classification for weather tightness:
 - Air permeability 600 Pa
 - Water tightness 200 Pa
 - Wind resistance 1200 Pa
 - Exposure category 1200 Pa

Security Performance

- > PAS 23-1:1999 - Clauses 6.3 - 6.11 and 6.14
- > PAS 24: 2007 + A1: 2009 - Clauses A.4 - A.11

Glazing

- > 28mm glazing unit. Air vent incorporated with glazing. Louvers option. Square and bevel beading options.

Other options

- > Electric latch, 5 point locking, panic exit device, low threshold, automatic closure, restrictor and handle styles.

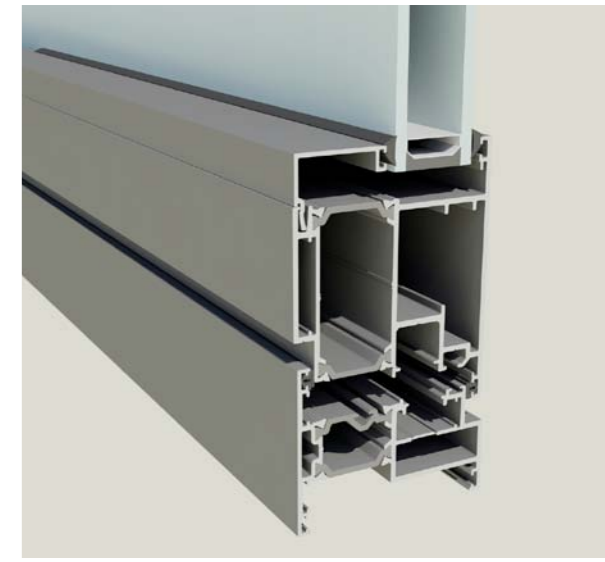

Why choose Climate II PA Door:

- > Internally beaded
- > 3 point locking
- > 70mm profiles
- > Three chamber thermal barrier
- > Achieves U-value complying with part L of the Building Regulations
- > Accommodates louvers, air vents and slot vents
- > Enhanced security hardware
- > Longer life
- > Easy to manufacture
- > Increase value of any property
- > Dual colour option
- > Non rusting and maintains strength
- > Guaranteed paint finishes
- > Lower energy consumption
- > Low threshold option
- > Appealing appearance
- > Easy to install
- > Panic exit device and electric latch option
- > Assembled on site
- > 3 chamber thermal barrier incorporated

“ a system with thermal performance...
...commercial and residential applicability...
... rigorous weather and security testing...
... durability for longer lifecycle...
... stunning appearance ... ”

f STAYFIX
ARCHITECTURAL ALUMINIUM SYSTEMS

53 Park Royal Road, Park Royal, London, NW10 7LQ

Tel: 020 8961 9030 Fax: 020 8961 9484 Email: sales@stayfix.co.uk

www.stayfix.co.uk

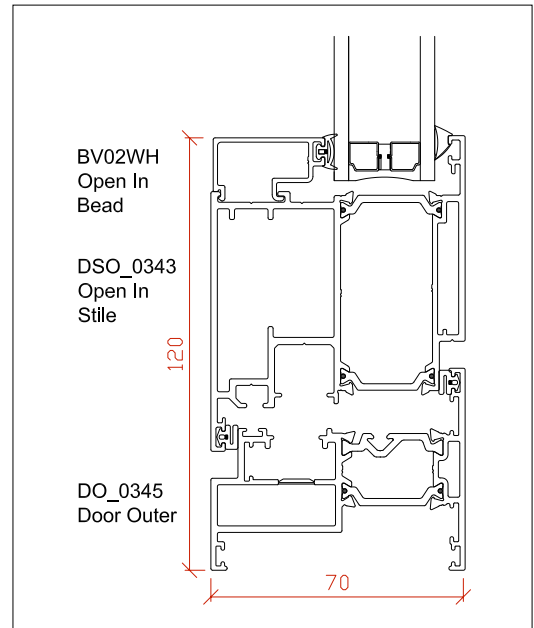

> Open in door sash

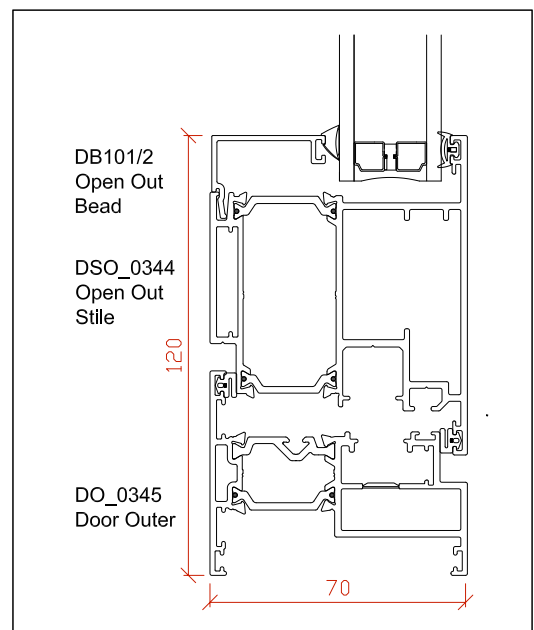

> Open out door sash