

f STAYFIX

ARCHITECTURAL ALUMINIUM SYSTEMS



iC 2

Intelligent Climate
Window system

iC 2

The iC 2 system is a series of aluminium profiles that have been designed to meet the standards of the ever growing challenges within the industry.

As well as reducing energy costs, it takes the effort away from manufacturing and installing, and the final appearance surpasses any other systems available.

To satisfy residential, as well as commercial requirements, iC 2 is adaptable with all sections in the range, being able to pair up with each other to create the desired type of end product. The system has been designed to be internally, as well as externally beaded, with a choice of three outer frames and five sash profiles. All interchangeable with each other.

Having a maximum polyamide thermal break of 28mm and only 63mm depth of profile, the system can achieve low U-values to accommodate the demands expected from the industry. Using triple glaze, the system can exceed U-values stated in Part L of the building regulations.



> Shootbolt as well as mushroom locking for security

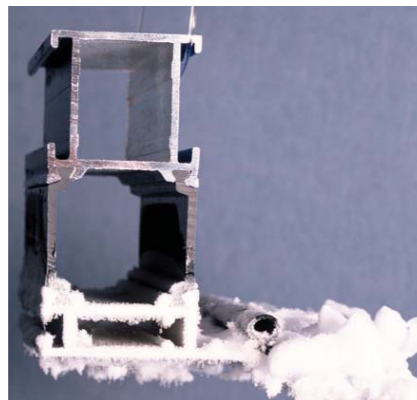

> Demonstration of polyamides resistance to low temperatures

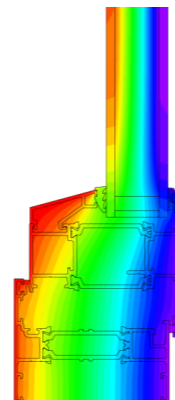

> Thermal conductance through the system

Technical specification

System options

- > Three outer options: Directfix, slim direct fix and oddleg
- > Five vent options: ovolo externally beaded sash, flat externally beaded sash, flat internal beaded sash, slim bevel internally beaded sash, standard internal beaded and crittal internal beaded.

Material

- > Extruded from aluminium alloy 6060 T6
- > Polyamide 6.6.25% reinforced with glass fibre

Finishes

- > Polyester powder coated to BSEN 12206
- > Qualicoat and GSB label
- > Mill Finish
- > Dual Colour options
- > Gloss, Matt and Satin on any RAL colour

System Features

- > Internally beaded for extra security
- > Fully compliance with Part L of the building regulations
- > Three chamber design
- > Simple to manufacture and install
- > Bayonet style bead specially designed to withstand forced entry
- > Top hung or side hung openings
- > Heavy Duty hinges

Application

- > Residential as well as commercial
- > For low to medium rise building

Weather Performance

- > BS 6375 Classification for weather tightness:
 - Air permeability 600 Pa
 - Water tightness 600 Pa
 - Wind resistance 2000 Pa
 - Exposure category 2000 Pa

Security Performance

- > PAS 24 security and strength tested to :
 - Manual check test
 - Manual infill removal
 - Mechanical infill removal
 - Mechanical loading test
 - Manipulation test

Glazing

- > 28mm glazing unit.
- > Air ventilaton within the glazing element
- > Louvers option.

Other options

- > System is designed to accommodate various security and operation components. Also can be accommodated into other systems.

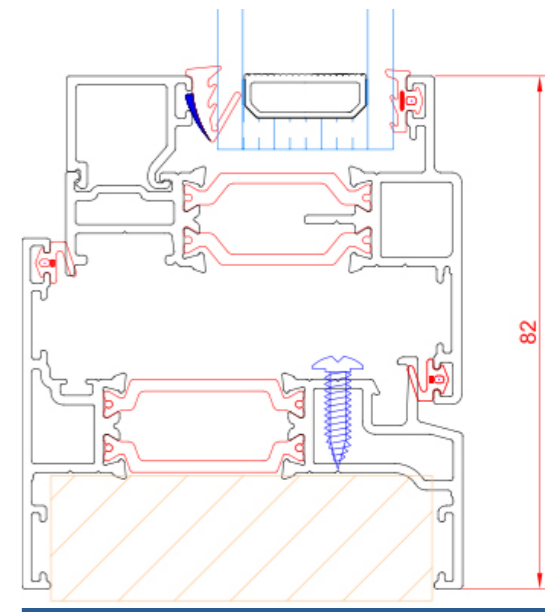
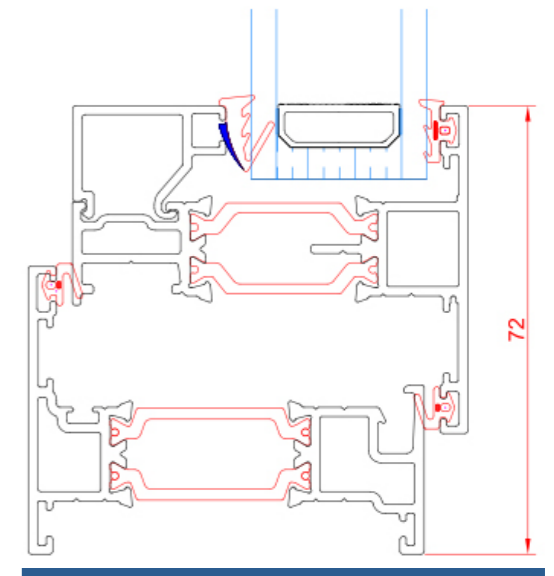
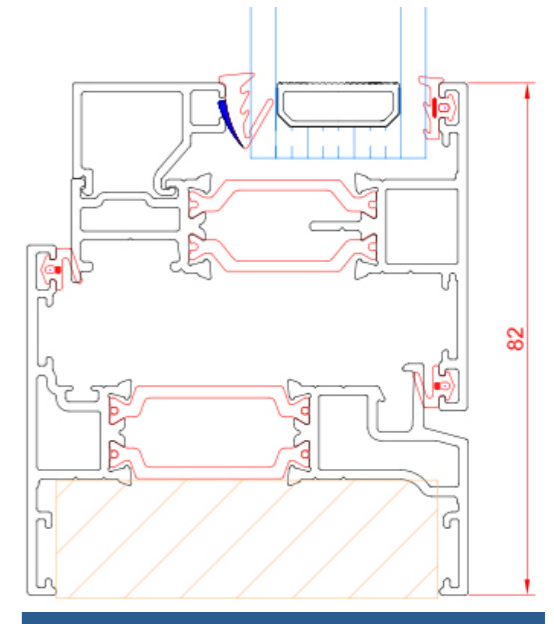

Why choose iC 2:

- > Internal and external beading option
- > Low profile depth
- > Three chamber design
- > Achieves U-value complying with part L of the Building Regulations
- > Enhanced security hardware
- > Longer life
- > Simple and easy to maintain
- > Increase value of any property
- > Accommodates louvers, air vents and slot vents
- > Dual colour option
- > Non rusting and maintains strength
- > Guaranteed paint finishes
- > Lower energy consumption
- > Profile options to mix and match
- > Appealing appearance
- > Easy to install
- > Option of fixing into timber frame
- > Bayonet style bead designed to withstand forced entry

“ a system with thermal performance...
... residential and commercial applicability...
... rigorous weather and security testing...
... durability for longer lifecycle...
... stunning appearance ..”

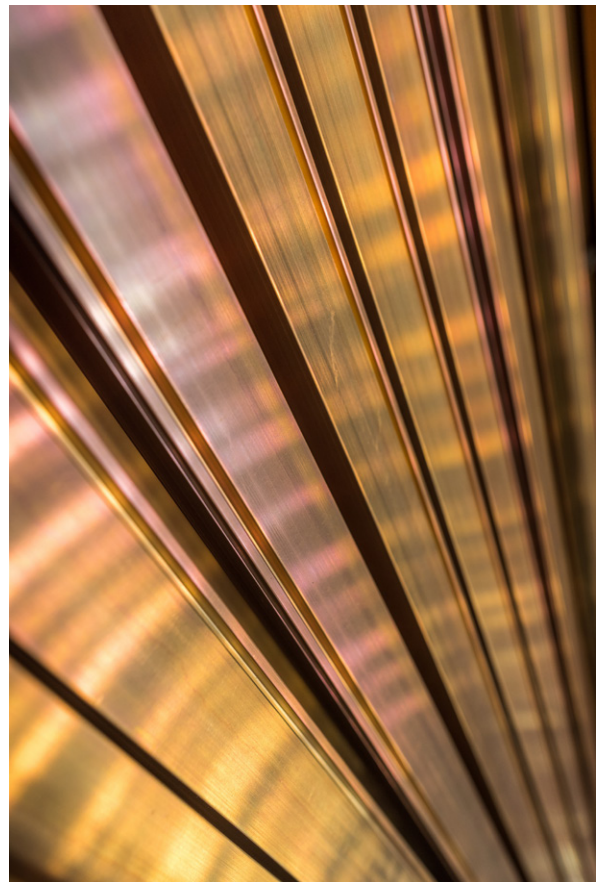

f STAYFIX

ARCHITECTURAL ALUMINIUM SYSTEMS

53 Park Royal Road, Park Royal, London, NW10 7LQ

Tel: 020 8961 9030 Fax: 020 8961 9484 Email: info@stayfix.co.uk

www.stayfix.co.uk