

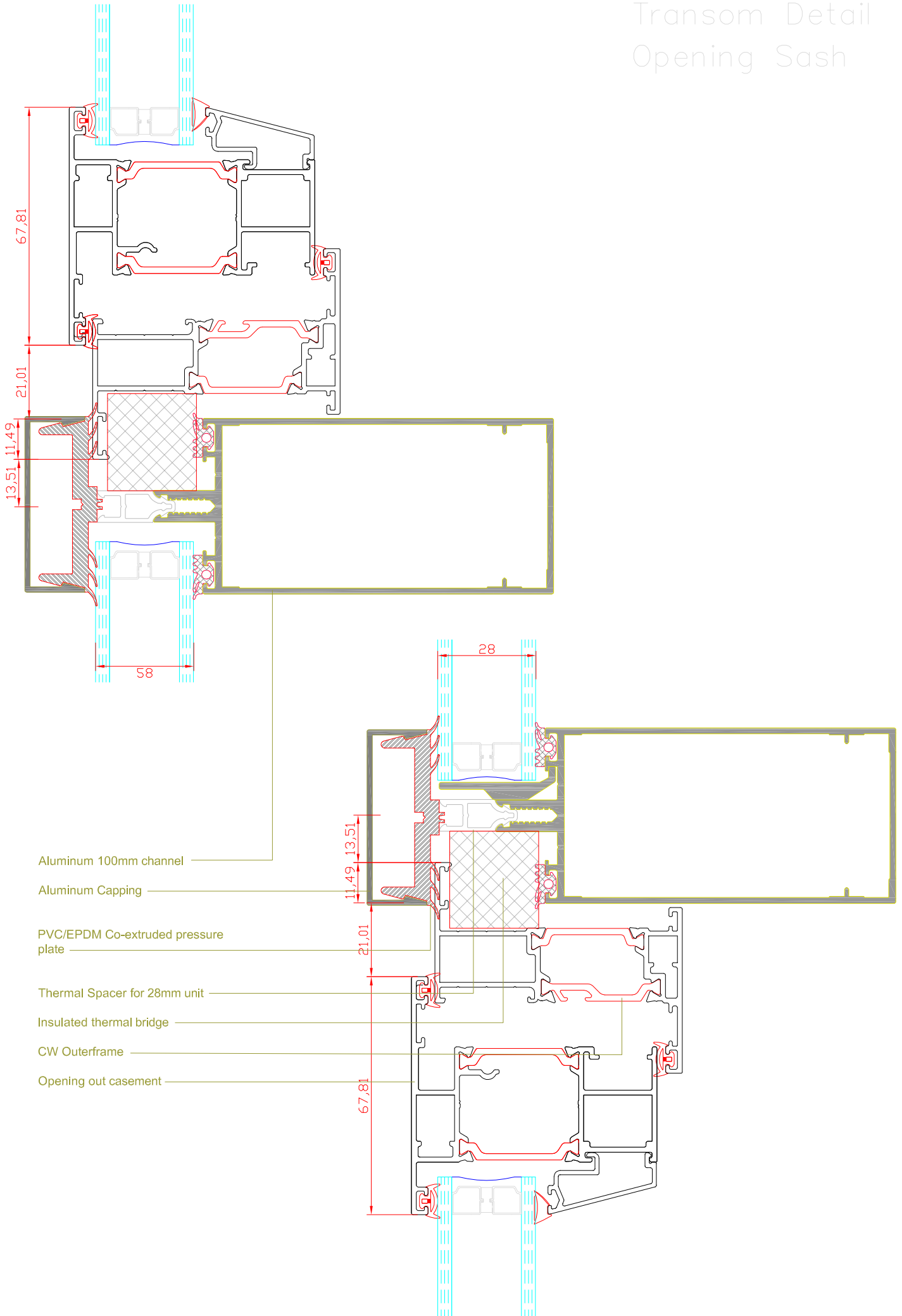

Transom Detail Opening Sash



Aluminum 100mm channel

Aluminum Capping

PVC/EPDM Co-extruded pressure plate

Thermal Spacer for 28mm unit

Insulated thermal bridge

CW Outerframe

Opening out casement

67,81

21,01

13,51

11,49

58

28

11,49

13,51

21,01

67,81